

FLOOR TRACKS

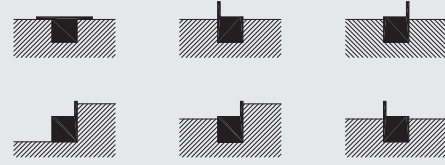

CONFIGURATION VARIANTS

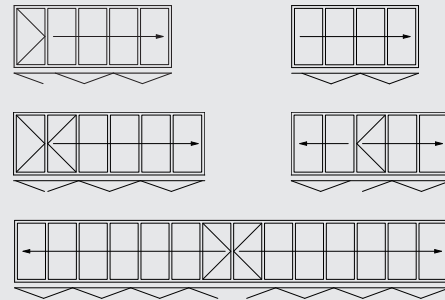

VERTICAL SECTION

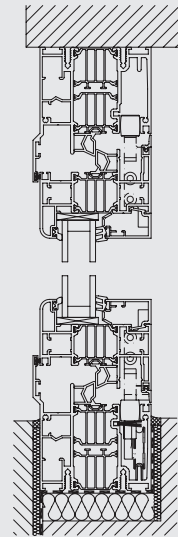

PANEL SIZE CHART

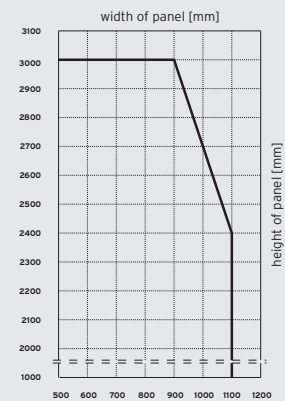

VARIANTS

- Available as floor-mounted folding glass door
- Panels can be ordered to open either internally or externally, to the left and/or right

PROFILE SYSTEM

- 80 mm thickness, multi-cavity system with 31 mm thermal break
- Slim frame and panel profiles (panel joint 104 mm)
- Softline (SL 80) or angular profile (SL 81)
- Flush floor track without upstand for disabled access available
- Tilt and turn panel within folding panel possible
- Sealing against wind and rain by double wraparound seal

WINDOW/DOOR SYSTEM

- Complete window systems to match folding glass façade: tilt and turn, parallel slide and tilt, fixed units

FITTINGS

- No protruding runner and guide tracks
- Concealed fittings for one-handed operation
- Lockable in any partly open position

GLAZING

- Heat-insulating glass as standard
- $U_g = 1,1 \text{ W/m}^2\text{K}$ with 2 x 4 mm float glass
- Triple-glazing available
- Overall thickness of the sealed units 24 to 44 mm

U-VALUE

- $U_w = 1,1 \text{ W/m}^2\text{K}$ ($U_g = 0,7 \text{ W/m}^2\text{K}$, insulated seldge) according to DIN EN ISO 10077 on the basis of a three-panel folding glass door, WxH 2700 x 2300 mm

SURFACE FINISH

- Powder coating to RAL
- Anodised aluminium to EURAS

MAXIMUM PANEL SIZES

- 1100 x 2400 mm
- 900 x 3000 mm
- Panel weight up to 100 kg
- Special sizes on request

TESTED FOR

- Ventilation Class 4 to DIN EN 1026 / 12207
- Impermeability to rain Class 9A to DIN EN 1027 / 12208
- Resistance to wind Class 3 to DIN EN 12211 / 12210
- Long-term functional performance Class 3 to DIN EN 1191 / 12400 (20,000 operations)



FOLDING GLASS DOOR
SL 80/81



WIDTH/HEIGHT ADJUSTMENT

Even after installation the folding glass door can be easily height-adjusted by about 8 mm - which is important if settling of the building occurs.



TRANSPARENCY

Narrow frame and panel profiles afford maximum view without compromising stability.

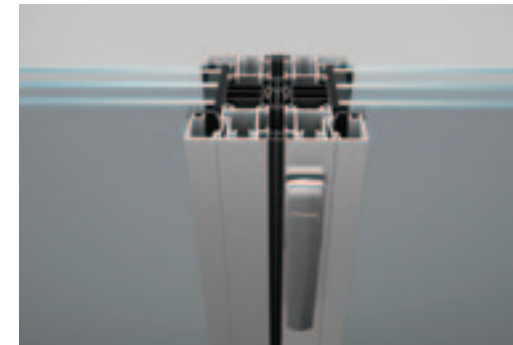

SAFE OPERATION

The swing panel is locked by means of a special catch and can thus be carried along safely.



COMFORT

The integrated multi-point locking system and the comfortable door handle with catch bolt, lock and profile cylinder lock ensure high security.



HEAT INSULATION

Stable, multi-chamber profiles with quadruple thermal insulation and double or triple-glazing provide the best heat insulation meeting the latest European Energy saving regulations (EnEV).

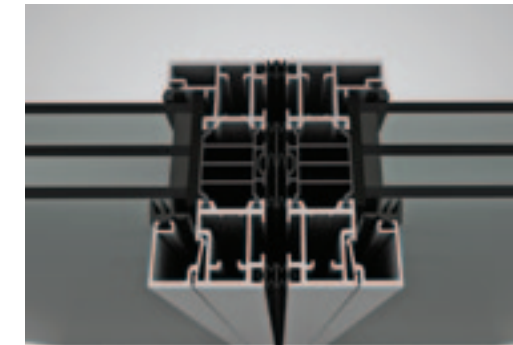

STABILITY

Espagnolettes with 24 mm throw lock the panels into the top and bottom track of the frame ensuring they withstand gales and afford high security.



FURNITURE

Concealed corrosion-resistant stainless steel fittings ensure clear profile lines and safety. When the folding glass door is open, the panel stack is compact.

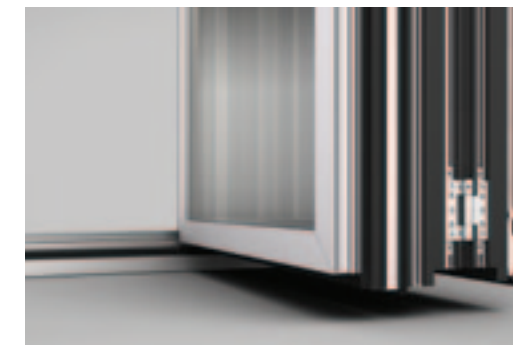

ENGINEERED

Long-lasting stainless steel runners and tracks ensure easy, quiet and smooth operation of the folding glass doors.

