

FLOOR TRACKS

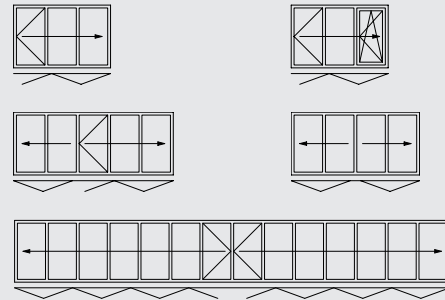

CONFIGURATION VARIANTS



VERTICAL SECTION

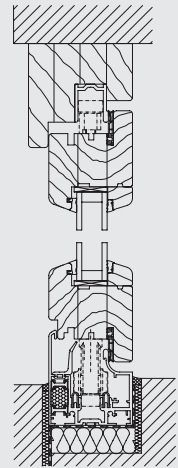

PANEL SIZE CHART

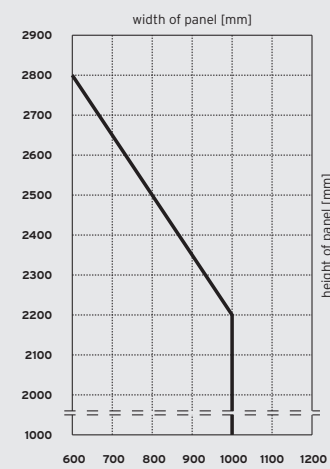

VARIANTS

- ▮ Floor mounted folding glass door
- ▮ Panels can be ordered to open either internally or externally, to the left and/or right

PROFILE SYSTEM

- ▮ 66 mm panel thickness
- ▮ Slim frame and panel profiles (panel joint 169 mm)
- ▮ Triple glue-laminated panel, frame with solid mortice and tenon joints
- ▮ Increased stability due to strength of aluminium profile for retention of door furniture
- ▮ Standard timber: pine or spruce, other timbers optional
- ▮ Flush floor track without upstand for unhindered access available
- ▮ Tilt and turn within folding panel possible
- ▮ Double wraparound seal protects from wind and rain
- ▮ Manufactured from a renewable source of timber

WINDOW/DOOR SYSTEM

- ▮ Can be combined with SL 68HA standard window systems: Tilt and turn, fixed units, parallel slide and tilt, etc.

FITTINGS

- ▮ No protruding runner and guide tracks
- ▮ Concealed fittings for one-handed operation
- ▮ Lockable in any partly open position

GLAZING

- ▮ Heat-insulating glass as standard
- ▮ Glass thickness from 5 to 28 mm available

SURFACE FINISH

- ▮ Wood finish according to SL colour chart: ecologically friendly water-based lacquer

U-VALUE

- ▮ $U_w = 1,3 \text{ W/m}^2\text{K}$ ($U_g = 0,7 \text{ W/m}^2\text{K}$, insulated selvedge) according to EN ISO 10077 on the basis of a three panel folding glass door, WxH 2700 x 2300 mm

MAXIMUM PANEL SIZES

- ▮ 1000 x 2200 mm
- ▮ 600 x 2800 mm
- ▮ Panel weight up to 70 kg
- ▮ Special sizes on request

TESTS

- ▮ Ventilation Class 3 to EN 12 207
- ▮ Impermeability to rain Class 9A to EN 12 208 (corresponds to test group C according to EN 18 055)
- ▮ Resistance to wind Class C 4 to 12 210
- ▮ Resistance class WK2 according to DIN V ENV 1627-1630: 1999-4



5670208-900 / 09/2011 / subject to technical changes



FOLDING GLASS DOOR
SL 66



SAFE OPERATION

The entry / exit panel can be secured by means of a special catch and can be carried along safely with the moving façade.



ENGINEERED

Stainless steel runners and tracks ensure an effortless sliding action of the folding glass door. Easy to open and to close.

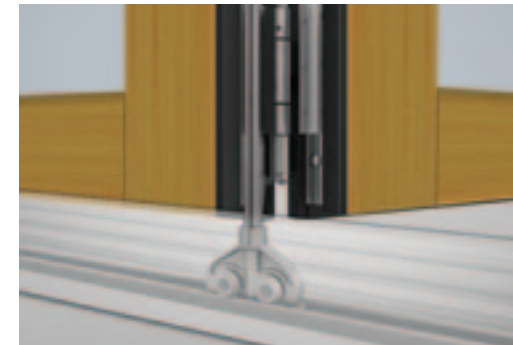

HEAT INSULATION

High-quality wood offers the best heat insulation according to the latest energy conservation regulations (EnEV).

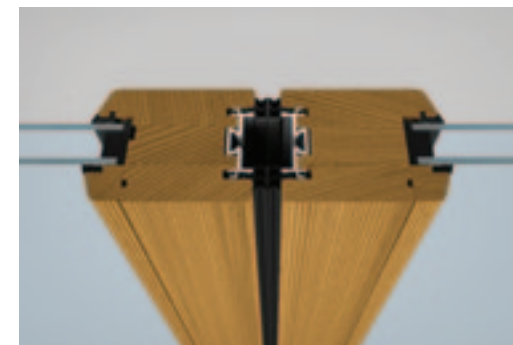

EASE

Natural wood creates a warm and natural atmosphere. A wide variety of colours and timbers are available creating exciting design possibilities.



SECURITY AND COMFORT

The integrated multipoint locking system and the comfortable door handle with catch bolt, lock and profile cylinder ensure high security. Optional with resistance class 2 available.



SUSTAINABILITY

Certified woods from sustainable forests are available as an optional extra. All components are tested to be environmentally-friendly and are mechanically connected to each other which means they can be separated easily for recycling.



STABILITY

24 mm throwbolts provide additional stability to the system and also increase security.



WIDTH/HEIGHT ADJUSTMENT

Even after installation the folding glass door can be easily height-adjusted by about 8 mm - which is important if settling of the building occurs.

